

High Power Bi-directional TVS

Compliance Standard

- ◆ IEC 61000-4-2
- ◆ IEC 61000-4-4
- ◆ IEC 61000-4-5
- ◆ EN 50121

Application

- ◆ Industrial
- ◆ Railway Application
- ◆ Surveillance
- ◆ Measurement

Features

- ◆ 1500W Peak Pulse Power
- ◆ Quick Response
- ◆ Low Clamping Voltage
- ◆ Low Leakage Current

Mechanical Characteristics

- ◆ SMBF Package
- ◆ Weight 98 Milligram (Approximate)
- ◆ Flammability Rating UL94V-0
- ◆ Lead Free Plating
- ◆ Reel Size 13"
- ◆ 3,000 PCS Per Reel

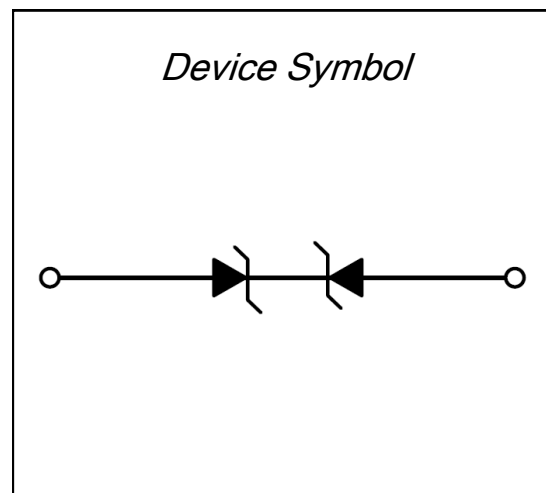
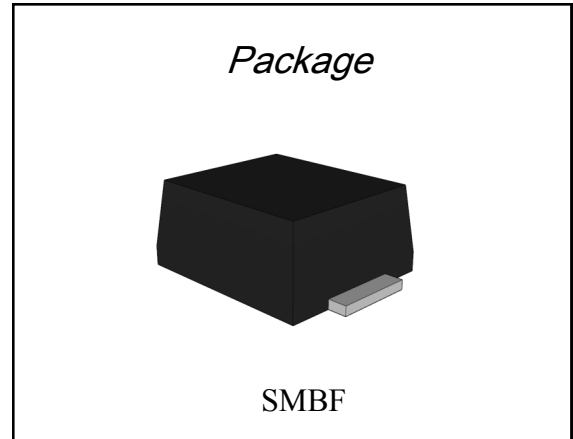

DEVICE CHARACTERISTICS

Maximum Rating			
Parameter	Symbol	Value	Units
Peak Pulse Power	P_{PP}	1500	Watt
Lead Soldering Temperature	T_L	260 (10s)	$^{\circ}C$
Operating Temperature Range	T_J	-55~150	$^{\circ}C$
Storage Temperature Range	T_{STG}	-55~150	$^{\circ}C$

Electrical Characteristics (@25 $^{\circ}C$)							
Part Number	V_{RWM} (Volt)	V_{BR} (Volt)	I_T (mA)	V_C (Volt)	I_{PP} (A)	I_R (μA)	C_J (nF)
15SMB60CA	60	66.5	1	100	15	10	1

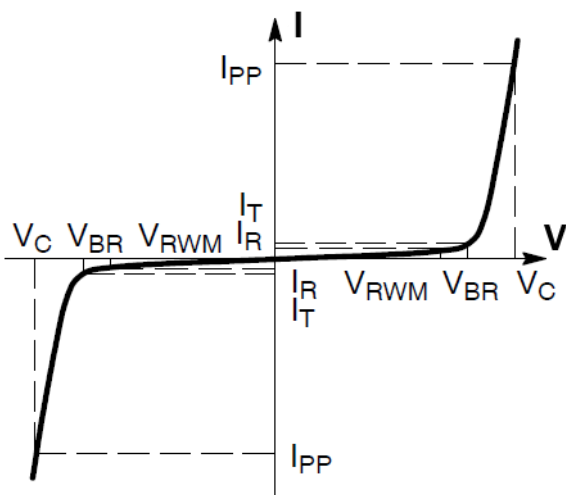

Figure1. I-V Characteristics

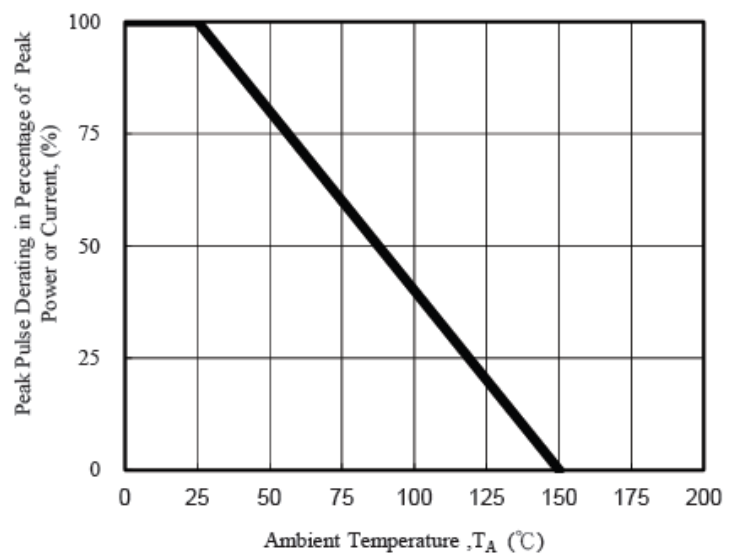
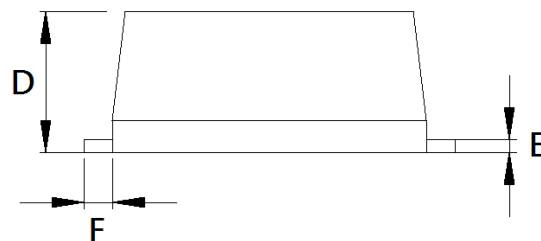
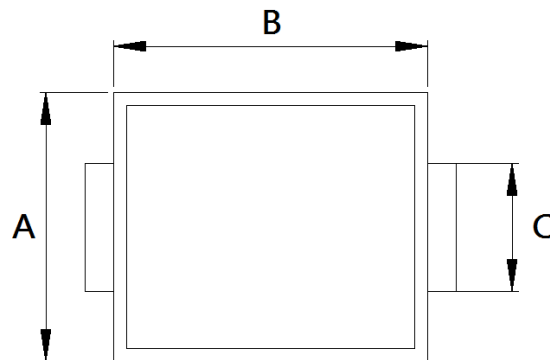

Figure2. Power Derating Curve

DEVICE OUTLINE

Outline Dimension				
Symbol	Millimeters		Inches	
	Min	Max	Min	Max
A	3.90	4.50	0.154	0.177
B	4.65	5.15	0.183	0.203
C	1.85	2.15	0.073	0.085
D	2.05	2.35	0.081	0.093
E	0.12	0.28	0.005	0.011
F	0.35	0.55	0.013	0.021



LAYOUT PAD DIMENSION

Layout PAD Dimension				
Symbol	Millimeters		Inches	
	Min	Max	Min	Max
A	6.80	7.40	0.267	0.291
B	1.90	2.10	0.074	0.083
C	2.10	2.50	0.083	0.098

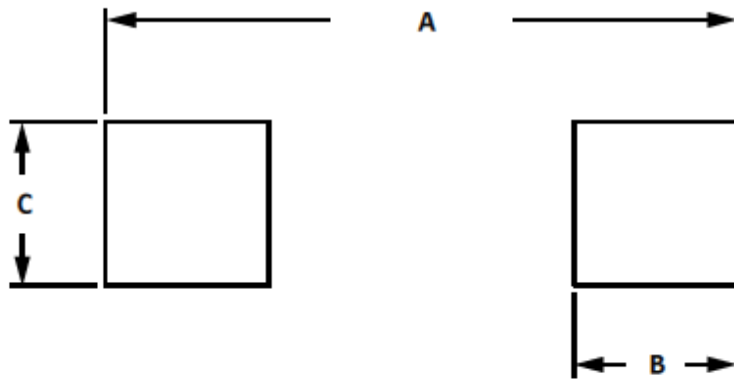

Revision History	Modification Description
Rev.1.0	Initial Release